

SPHERICAL PLAIN BEARING

Standard 210 Bar Series

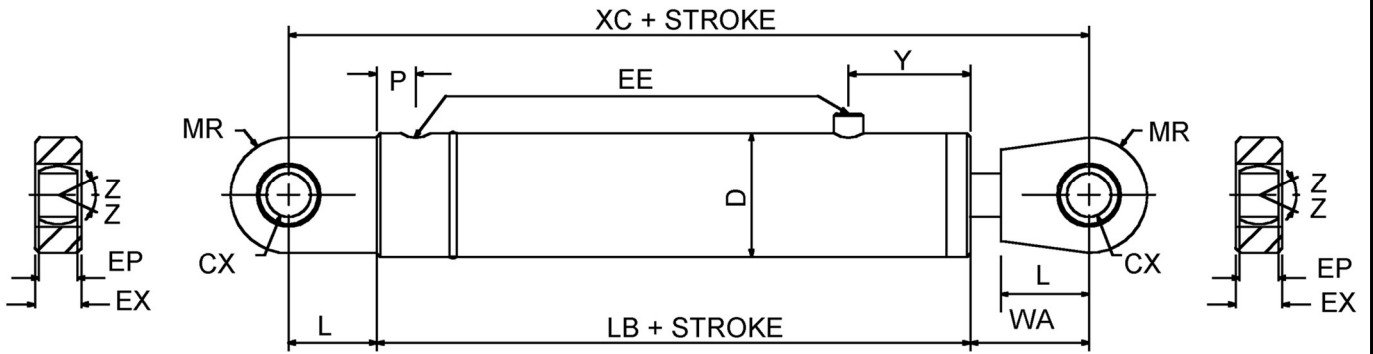

CYL BORE	ROD DIA	CX	D	EE bspp	EP	EX	L	LB	MR max	P	Y	WA	XC	Z
1.00"	0.50"	12.70	38	G1/4	16	11.1	20	94	19	13	32	32	146	6°
	0.62"													
1.25"	0.75"	15.88	44.5	G1/4	18	13.9	25	102	22	13	40	37	164	
	0.75"													
1.50"	1.00"	19.05	51	G3/8	20	16.7	32	131	25	15	50	48	211	
	1.00"													
2.00"	1.25"	22.23	63.5	G3/8	25	19.5	40	148	32	15	60	56	244	
	1.25"													
	1.50"													
2.50"	1.50"	25.40	76.2	G1/2	32	22.3	45	169	40	20	75	63	277	
	1.50"													
	1.75"													
3.00"	1.75"	31.75	88.9	G1/2	32	27.8	51	184	45	20	85	71	306	
	1.75"													
	2.00"													
3.25"	2.00"	38.10	95.3	G1/2	40	33.4	64	184	50	20	85	86	334	
	2.00"													
	2.25"													
3.50"	2.25"	38.10	101.6	G1/2	40	33.4	64	189	50	20	90	86	339	
	2.25"													
	2.25"													
4.00"	2.50"	44.45	114.3	G3/4	50	38.9	75	204	63	26	95	100	379	
	2.50"													
	2.50"													
	3.00"													
4.50"	3.00"	44.45	130	G3/4	50	38.9	75	219	63	26	100	100	394	
	3.00"													
	2.50"													
	3.00"													
5.00"	3.50"	50.80	146	G3/4	50	44.5	89	239	71	26	115	119	447	
	3.50"													
	3.50"													
6.00"	4.00"	63.50	171.5	G3/4	65	55.6	100	260	90	26	136	135	495	
	4.00"													
7.00"	4.50"	76.20	203.2	G1	80	66.7	140	293	112	34	155	178	611	
	4.50"													
8.00"	5.00"	76.20	228.6	G1	80	66.7	140	318	112	34	180	180	638	
	5.00"													