

ROUND FLANGE

Standard 210 Bar Series

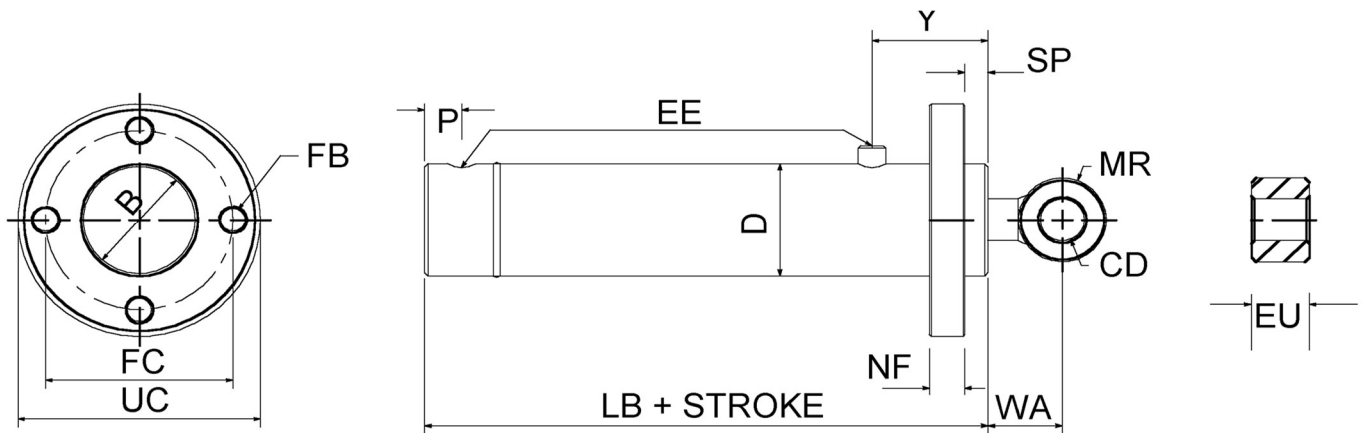

CYL BORE	ROD DIA	CD (H11)	D	EE bsp	EU	UC	FC	FB	MR max	LB	P	Y	WA	NF max	SP
1.00"	0.50"	12.70	38	G1/4	16	85	66	4x7	12.5	94	13	32	25	12	8
	19														
1.25"	0.62"	15.88	44.5	G1/4	19	95	74	4x9	16	102	13	40	28	12	10
	25														
1.50"	0.75"	19.05	51	G3/8	25	110	85	4x11	20	131	15	50	32	16	10
	32														
2.00"	1.00"	22.23	63.5	G3/8	32	130	102	4x13.5	22	148	15	60	38	16	10
	38														
	45														
2.50"	1.25"	25.40	76.2	G1/2	38	150	120	4x13.5	25	169	20	75	43	20	12
	45														
	50														
3.00"	1.50"	31.75	88.9	G1/2	45	170	138	4x17.5	32	184	20	85	52	20	13
	50														
	57														
3.25"	1.75"	38.10	95.3	G1/2	50	190	150	4x17.5	38	184	20	85	60	20	13
	57														
	63.5														
3.50"	1.75"	38.10	101.6	G1/2	50	205	165	4x22	38	189	20	90	60	25	14
	57														
	63.5														
4.00"	2.00"	44.45	114.3	G3/4	57	210	175	6x17.5	45	204	26	95	70	25	15
	63.5														
	76.2														
	90														
4.50"	2.00"	44.45	130	G3/4	57	230	195	6x17.5	45	219	26	100	70	32	15
	63.5														
	76.2														
	90														
5.00"	2.50"	50.80	146	G3/4	76.2	250	210	6x22	51	239	26	115	81	32	15
	90														
	102														
6.00"	3.00"	63.50	171.5	G3/4	90	300	255	8x22	60	260	26	136	95	40	16
	115														
7.00"	3.50"	76.20	203.2	G1	102	350	297	8x26	70	293	34	155	108	50	19
	115														
8.00"	4.00"	76.20	228.6	G1	115	380	325	8x26	75	318	34	180	115	65	19
	150														